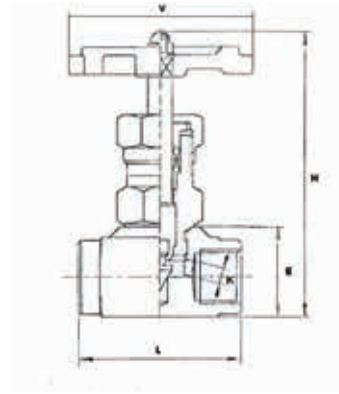
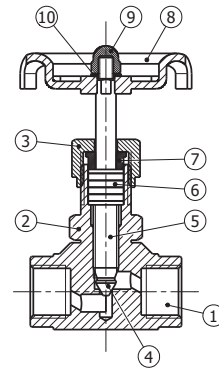
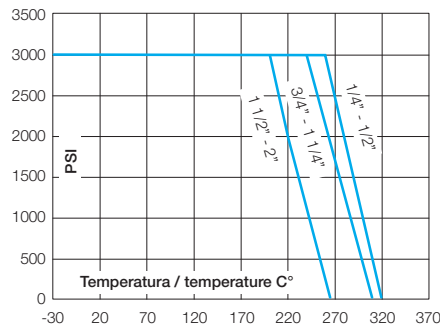
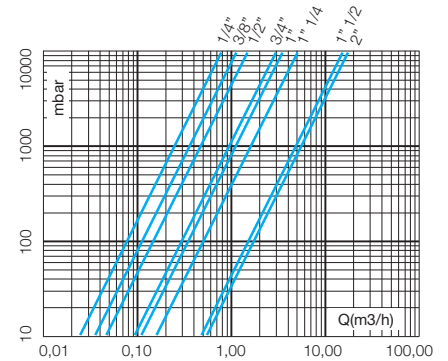

M2

H2223

Valvole a spillo /
Needle valvesModello / Model
H2223Materiale / Material
Aisi 316Tenuta / Seal
Metallica / MetallicDN
8 - 50PN
200Caratteristiche tecniche /
Construction features

- **Connessioni filettate femmina secondo /**
Threaded ends female according to
ISO 228/1
- **Pressione massima di esercizio /**
Maximum working pressure
200 bar (3000 Lbs)
- **Temperatura massima di esercizio /**
Maximum working temperature
240°C

Diagramma pressione temperatura /
Pressure temperature diagramPerdite di carico /
Friction losses diagramsDimensioni e pesi /
Dimensions and weights

Codice Code	Misura Size	DN	PN	Peso in kg. Weight in kg.	KV m³/h	Dimensioni in mm Dimensions in mm				
						E	H	L	K	V
H222302	1/4"	8	200	0,26	0,25	25	85	50	3	63
H222303	3/8"	10	200	0,36	0,36	30	100	55	4	63
H222304	1/2"	15	200	0,53	0,47	34	115	60	6	72
H222305	3/4"	20	200	0,76	0,95	40	120	70	8	72
H222306	1"	25	200	1,18	1,1	45	138	75	9	80
H222307	1" 1/4	32	200	1,85	1,6	57	165	90	11	100
H222308	1" 1/2	40	200	2,90	4,76	67	185	100	15	120
H222309	2"	50	200	4,70	5,36	78	195	120	18	140

Componenti e materiali /
Components and materials

1	Corpo / Body	ASTM A479-04 (316) / ASTM A182 F316
2	Coperchio / Cap	Acciaio inox / SS Aisi 316
3	Dado premistoppa / Nut	Acciaio inox / SS Aisi 316
4	Spillo / Needle	Acciaio inox A182 F316 / SS A182 F316
5	Albero / Stem	Acciaio inox A182 F316 / SS A182 F316
6	Pacco albero / Stem packing	PTFE + grafite / PTFE + graphite
7	Premistoppa / Packing nut	Acciaio inox / SS Aisi 316
8	Volantino / Handwheel	Ghisa / Cast iron
9	Dado / Nut	Acciaio inox / SS Aisi 304
10	Rondella / Washer	Acciaio inox / SS Aisi 304

Su richiesta /
On request

Filettatura NPT / NPT thread