

A 30 30

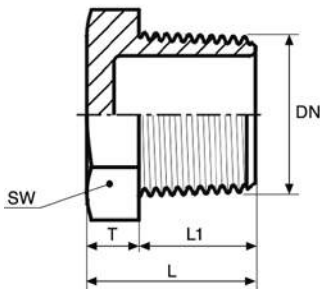

292

TAPPO MASCHIO TESTA ESAGONALE

- HEXAGONAL PLUG
- 6-KANT STOPFEN
- BOUCHON M. HEXAGONAL
- TAPÓN MACHO HEXAGONAL

MATERIAL: AISI 316 / 1.4401 / 1.4408
THREAD: EN 10226-1 (ex ISO 7/1)
RATING: 150 PSI – PN10

CODE	DN	DN inch	L mm	L1 mm	T mm	SW mm	g	kg	box	€
292108316	6	1/8"	17	8,5	8,5	12	12	10	1000	2,18
292104316	8	1/4"	17,5	12,5	5	16	20	10	800	1,91
292308316	10	3/8"	18	12	6	20	36	10	600	2,21
292102316	15	1/2"	25	16,5	8,5	24	51	10	300	2,52
292304316	20	3/4"	26	17,5	8,5	30	76	10	200	4,22
292100316	25	1"	29	20,5	8,5	38	119	10	120	5,31
292114316	32	1 1/4"	35	26,5	8,5	46	195	5	75	9,94
292112316	40	1 1/2"	38	26,5	11,5	52	297	5	60	14,26
292200316	50	2"	39	27,5	11,5	65	432	5	30	19,80
292212316	65	2 1/2"	44	30,5	13,5	81	806	3	15	36,88
292300316	80	3"	54	40,5	13,5	94	1164	2	12	53,36
292400316	100	4"	55	40,5	14,5	119	1961	2	10	90,72

A 30 30

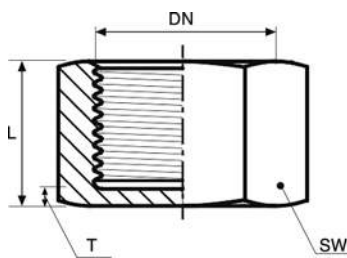

300

CALOTTA ESAGONALE

- HEXAGONAL CAP
- 6-KANT KAPPE
- BOUCHON FEMELLE HEXAGONALE
- TAPÓN HEMBRA HEXAGONAL

MATERIAL: AISI 316 / 1.4401 / 1.4408
THREAD: EN 10226-1 (ex ISO 7/1)
RATING: 150 PSI – PN10

CODE	DN	DN inch	L mm	T mm	SW mm	g	kg	€
300108316	6	1/8"	14	3	15	12	10	2,15
300104316	8	1/4"	18	3	18	21	10	2,15
300308316	10	3/8"	19	3	21	32	10	2,61
300102316	15	1/2"	21	3	27	58	10	3,27
300304316	20	3/4"	24	4	30	67	10	3,95
300100316	25	1"	25	4	38	116	10	5,89
300114316	32	1 1/4"	28	4,5	50	231	5	11,09
300112316	40	1 1/2"	28	4,5	55	254	5	12,55
300200316	50	2"	34	4	70	506	5	19,91
300212316	65	2 1/2"	40	6,5	92	1207	2	46,16
300300316	80	3"	45	6	109	1925	2	71,84
300400316	100	4"	50	6	132	2693	1	106,39